

Main Residence



AREA CALCULATIONS SUMMARY

LIVING AREA			
First Floor	2249.25 Sq Ft	20 x 18 =	360
		24 x 6 =	144
		28 x 6 =	168
		57.5 x 12 =	690
		47.5 x 3.5 =	166.25
		51.5 x 14 =	721
Second Floor	615 Sq Ft	20.5 x 30 =	615
Total Living Area (Rounded)	2864 Sq Ft		
NON-LIVING AREA			
1 Car Port	302 Sq Ft	24 x 12 =	288
		3.5 x 4 =	14

The information provided here has been obtained from the owner of the property or from other sources deemed reliable. We have no reason to doubt its accuracy, but we do not guarantee it.



Guest Lodge

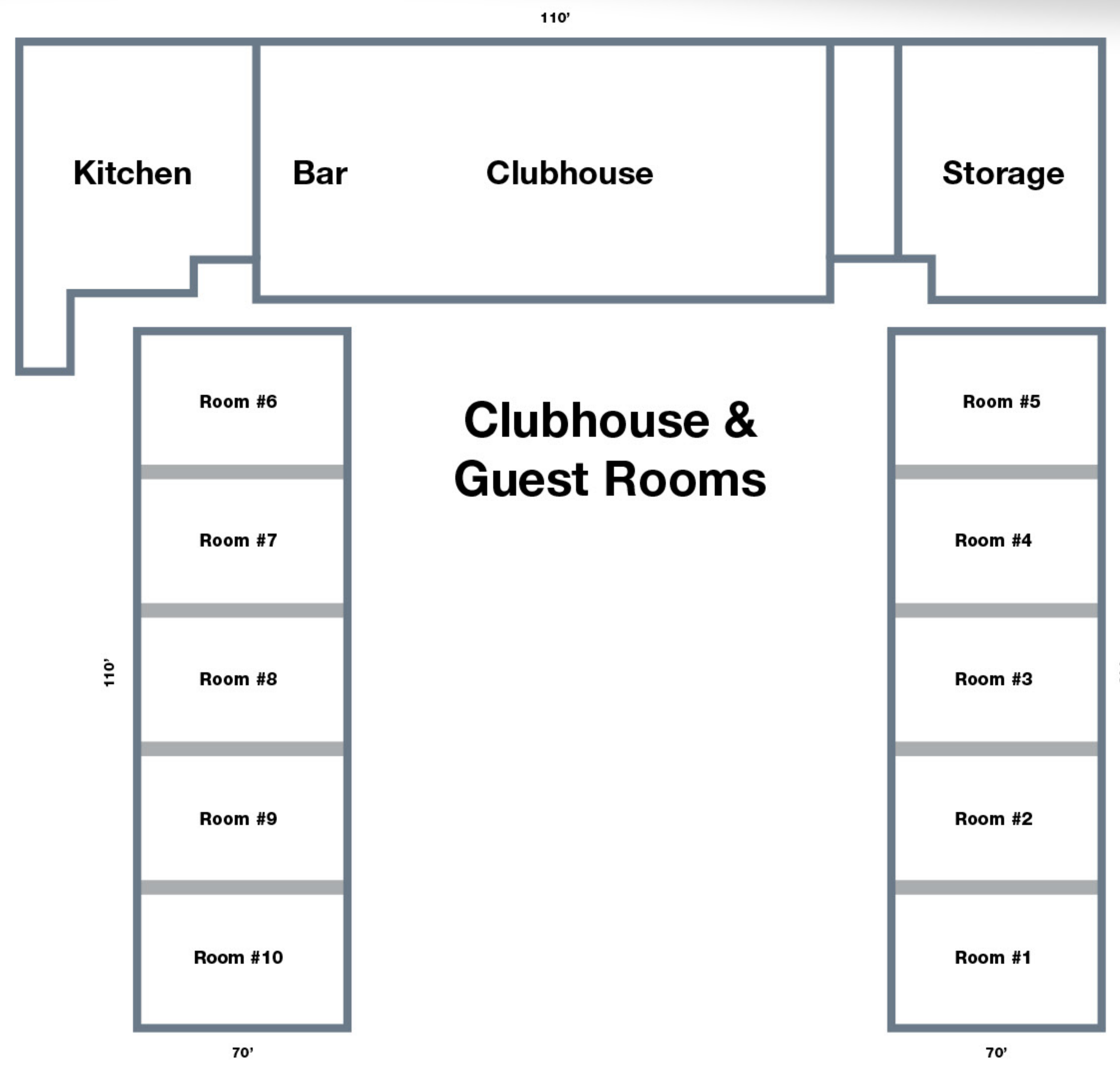

AREA CALCULATIONS SUMMARY

NON-LIVING AREA			
Guest Rooms	1540 Sq Ft	22 x 70	= 1540
Club House	2879.5 Sq Ft	60 x 3.5	= 210
		26 x 17	= 442
		5 x 8	= 40
		26 x 17.5	= 455
		77 x 22.5	= 1732.5
		22 x 70	= 1540
Total Non-Living Area (Rounded)	1830 Sq Ft		

The information provided here has been obtained from the owner of the property or from other sources deemed reliable. We have no reason to doubt its accuracy, but we do not guarantee it.

